

# Concise

Centered and Offset

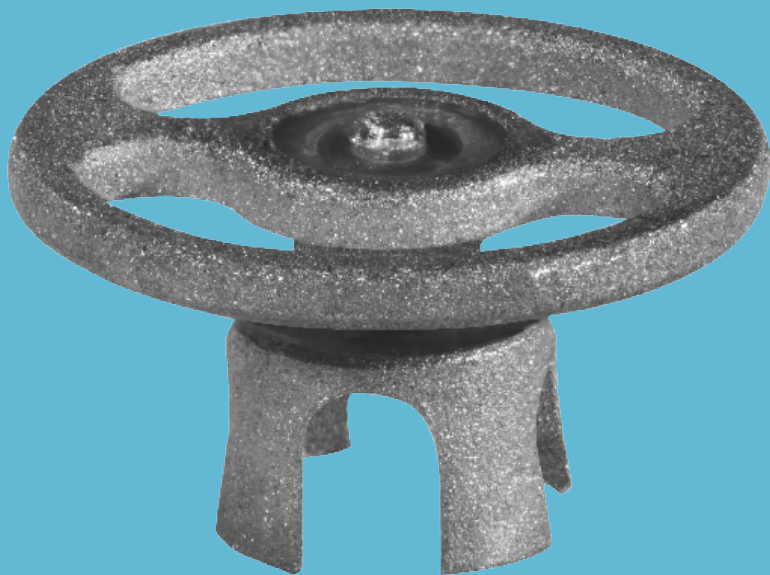
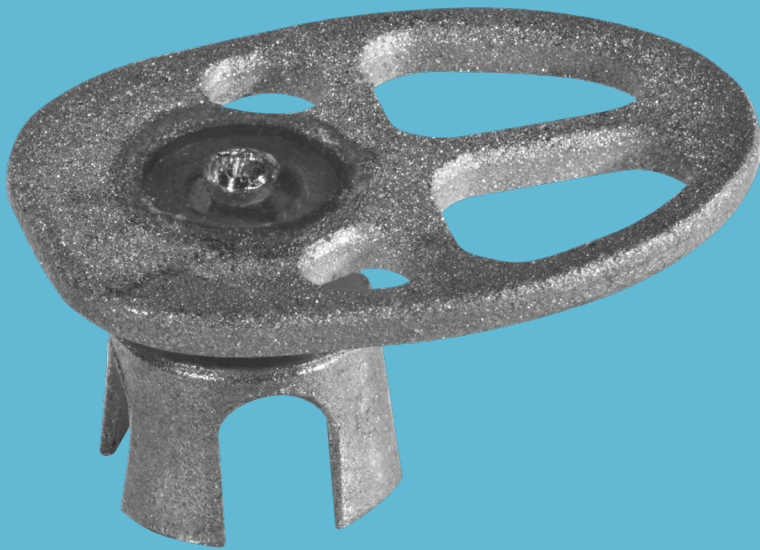

Grace Medical We Listen.

# Concise

## Centered and Offset

- Enhanced functional length from 0.75 to 5.75mm
- Multidirectional head for optimal contact with TM
- Reliability of original ALTO

REF. #	DESCRIPTION
650-075	Offset ALTO Concise Partial
655-075	Centered ALTO Concise Partial



**Grace Medical** We Listen.

©2018 Grace Medical, Inc. All Rights Reserved.

8500 Wolf Lake Drive, Suite 110  
Memphis, TN 38133 USA  
Phone 1.901.386.0990  
Fax 1.901.386.0950  
Toll Free 1.866.472.2363  
info@gracemedical.com  
www.gracemedical.com

LIT0202 CID6037 Rev. 2018-09